



CLIENT
Valkyrie Special Projects

PROJECT
Lego Table

DRAWN BY
SS

ISSUE
03.12.19

DATE MODIFIED
January 14, 2020

VERSION
1.0

Lego Table



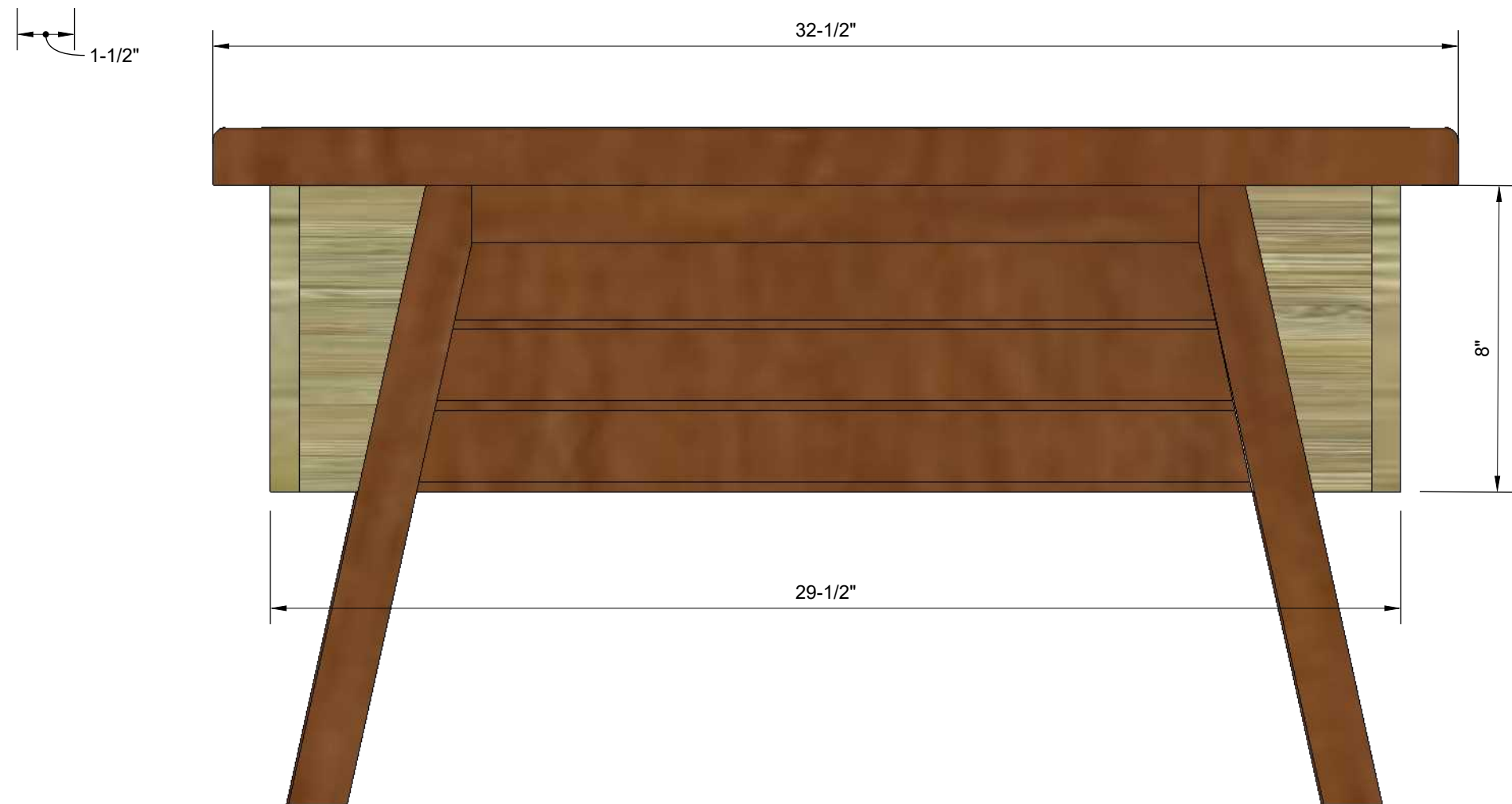
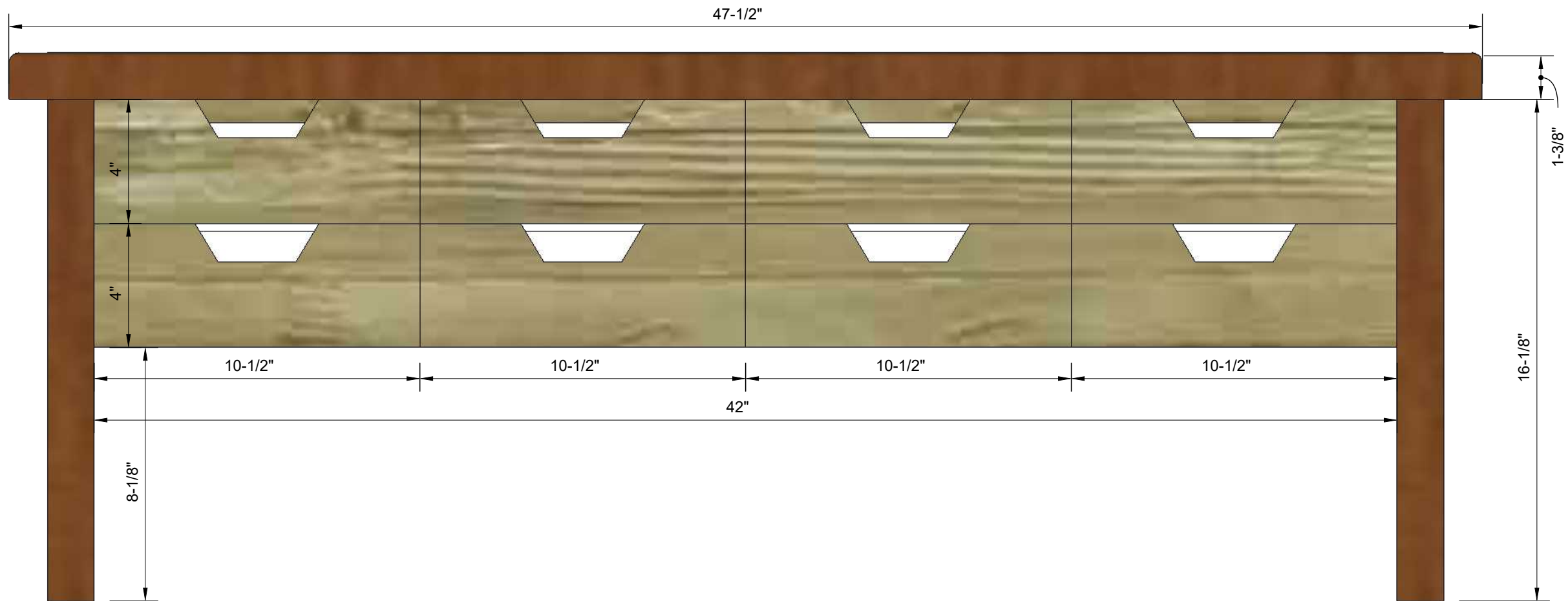

604-685-0029
261 Central St.
Vancouver, BC
V6A 4A9

valkyriewoodwork.com

COPYRIGHT RESERVED
THE COPYRIGHT TO THIS DRAWING
AND ITS CONTENTS IS RESERVED,
AND REMAINS AT ALL TIMES THE
EXCLUSIVE PROPERTY OF VALKYRIE
WOODWORK, AND SHALL NOT BE
USED, MODIFIED, OR REPRODUCED
WITHOUT THE EXPRESSED WRITTEN
CONSENT OF VALKYRIE WOODWORK

CLIENT
Valkyrie Special Projects

PROJECT
Lego Table

DRAWN BY
SS

DATE MODIFIED
January 14, 2020

VERSION
1.0

Elevation

A.01

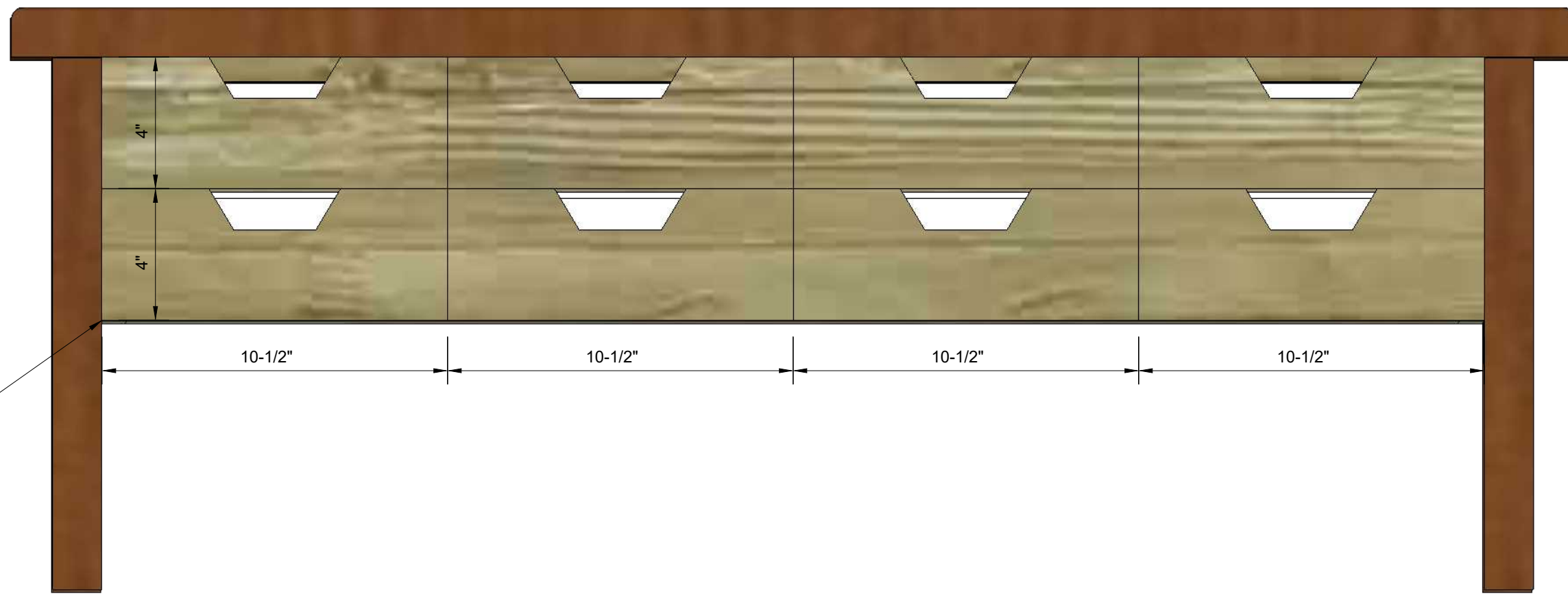

Allow 3mm gap
Between all fronts
4 sides

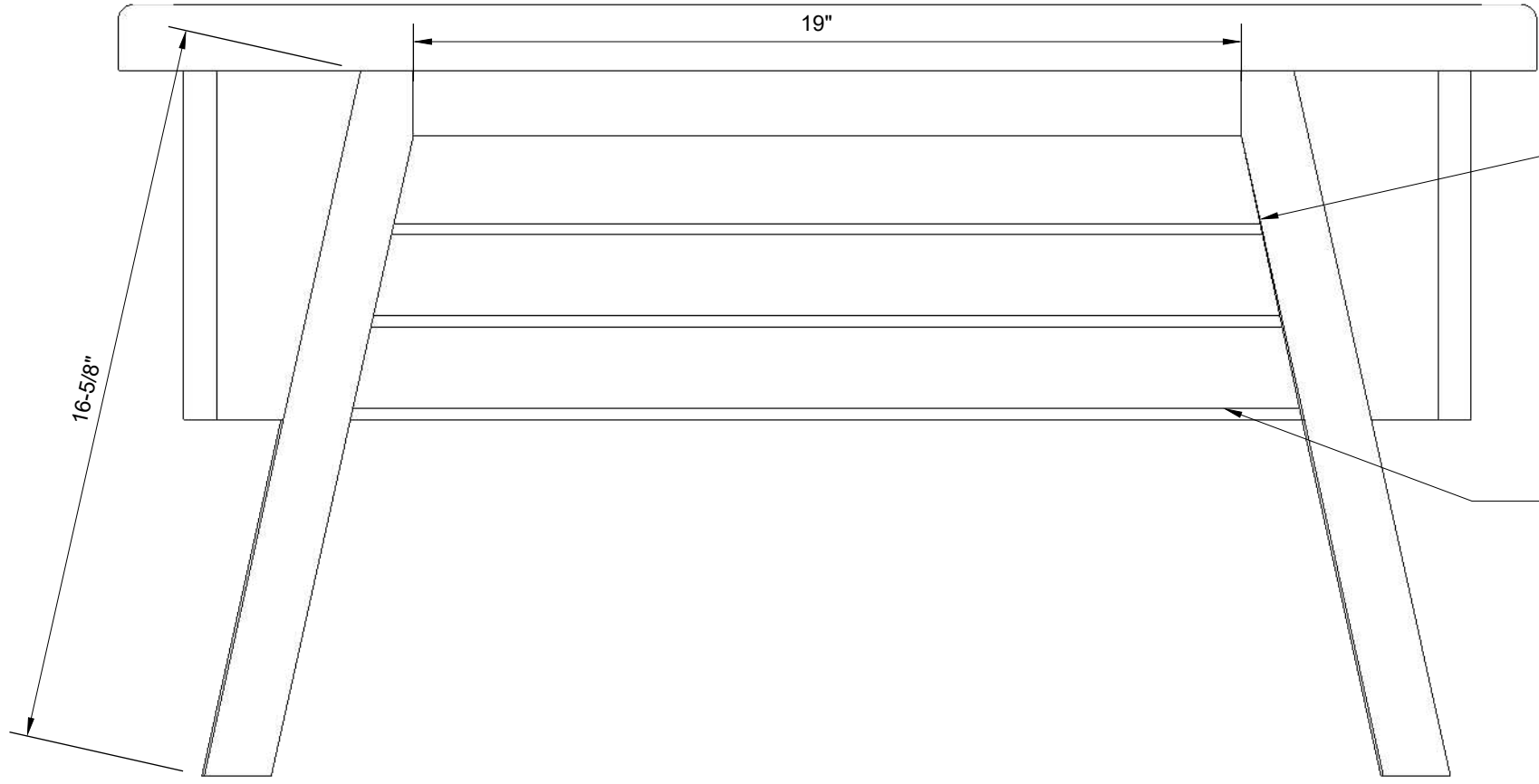

Slot in leg to let in shelf
Machine to fit your shelf material
1/4" -3/8" (whatever you like)

Apply lego tape cut to width
OR
machine in lego panels to suit
Minifig display

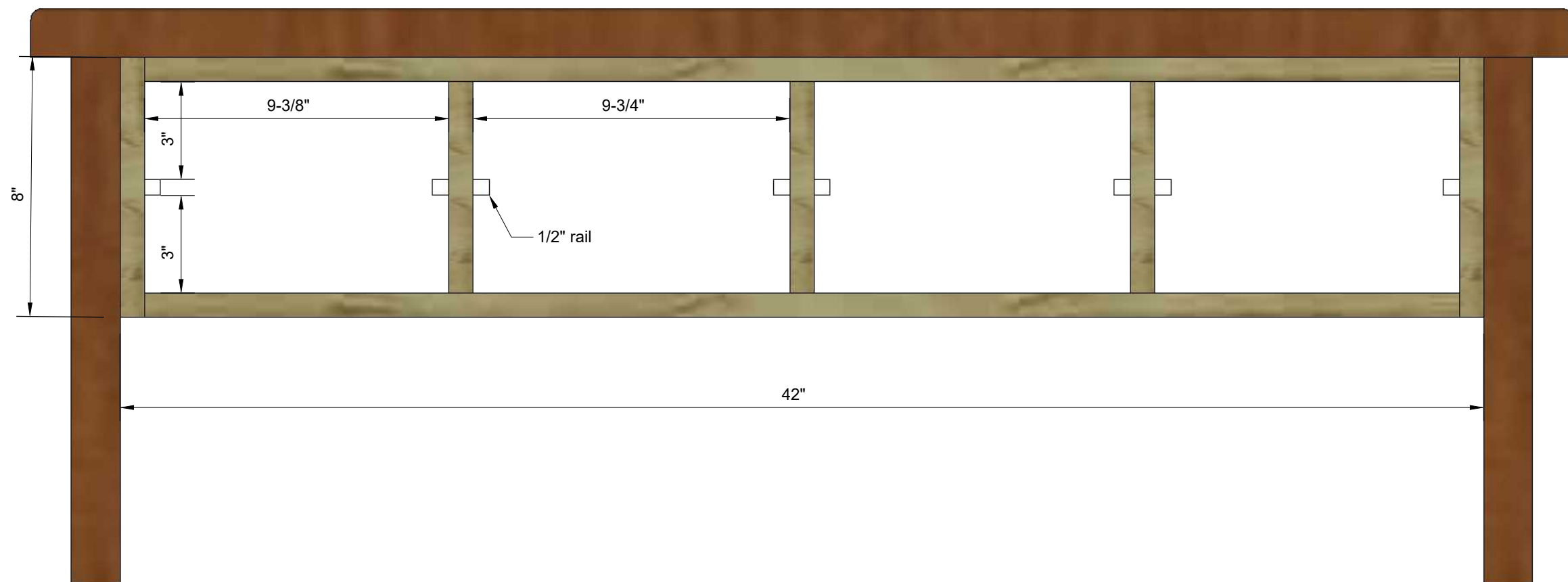
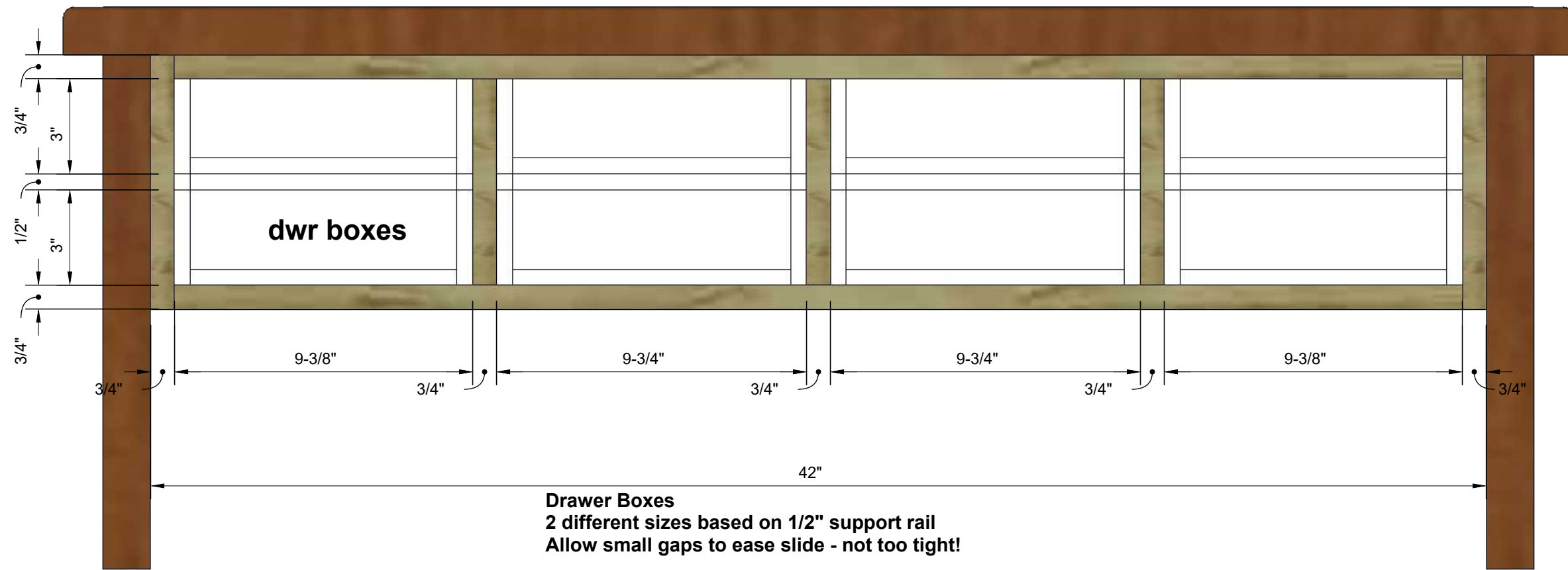

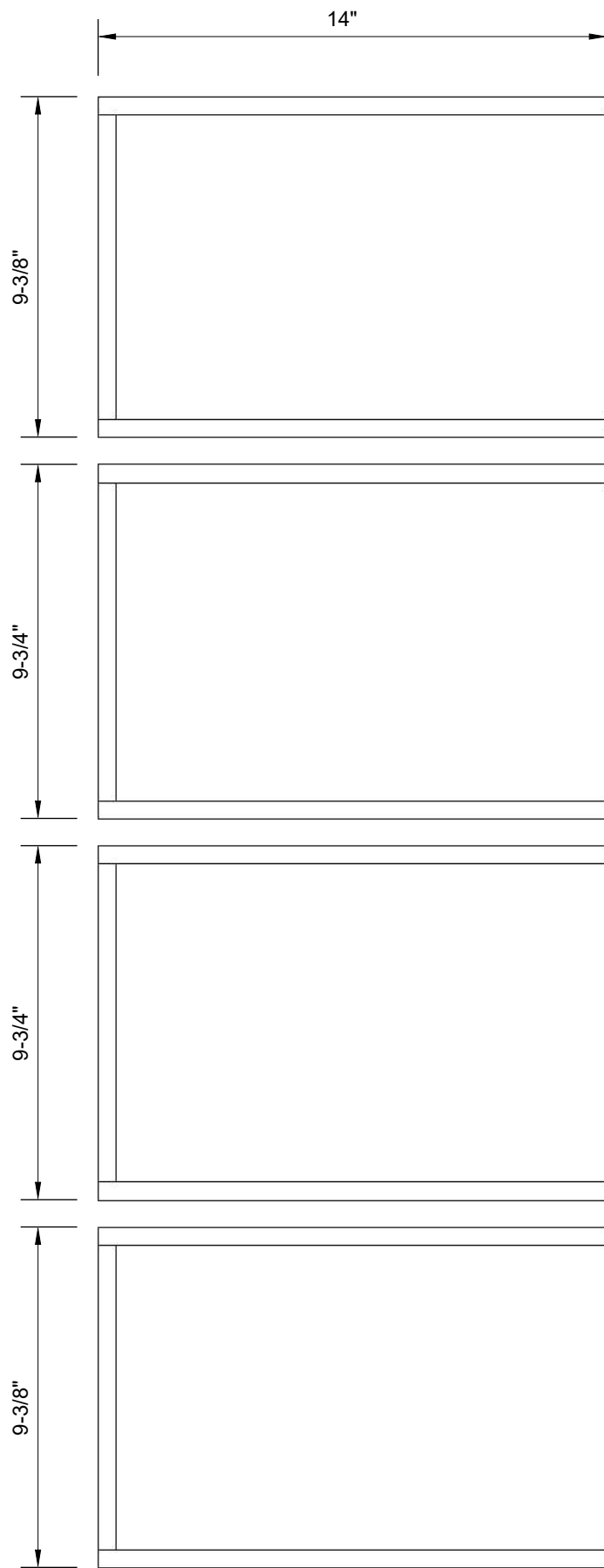

**Plan View
Drawer Boxes**

Table top 3/4" substrate
Edge at 1" material and thicker
Depends on preference

Biscuit and glue miter frame edge
to substrate

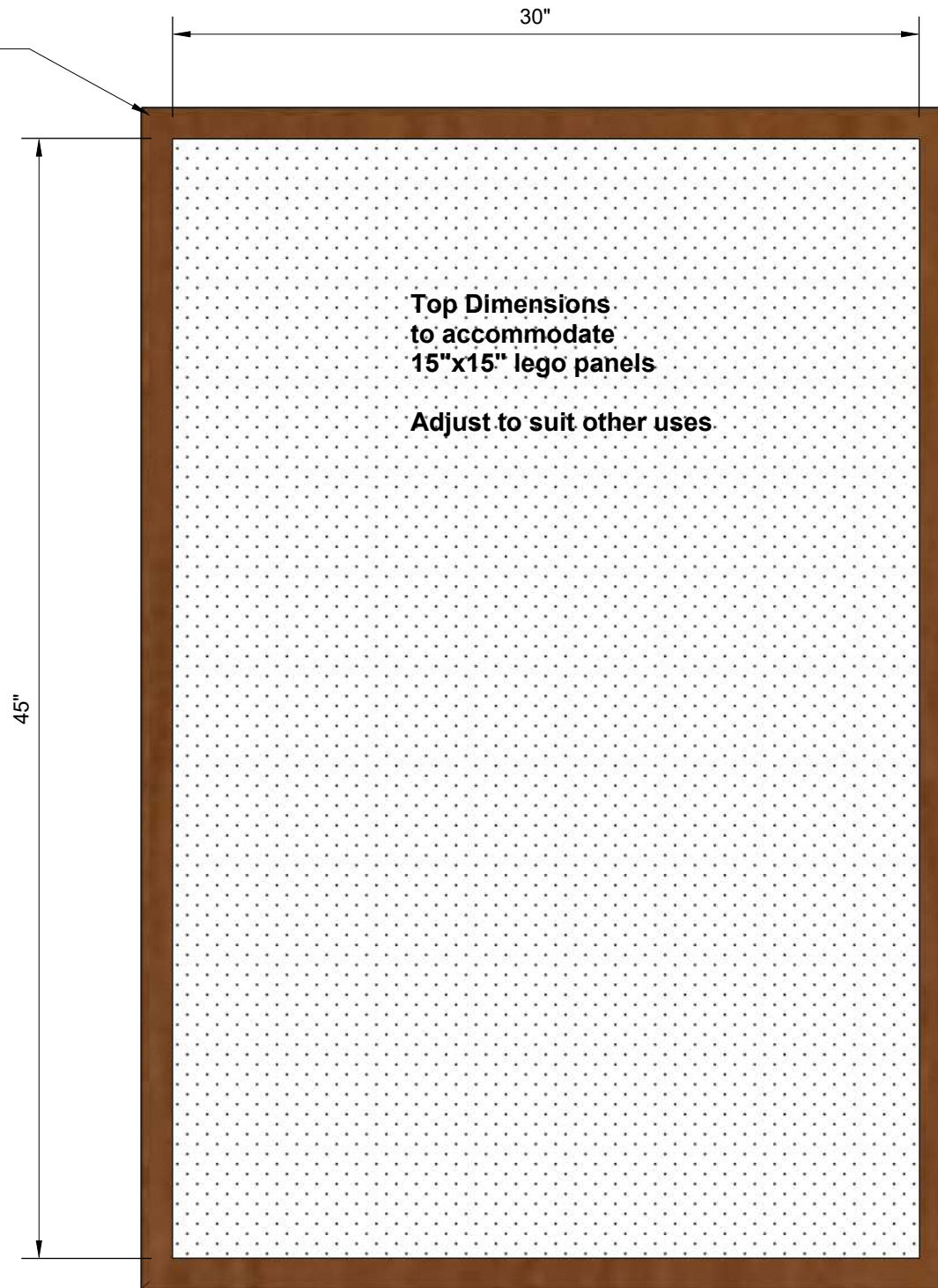

604-685-0029
261 Central St.
Vancouver, BC
V6A 4A9

valkyriewoodwork.com

COPYRIGHT RESERVED
THE COPYRIGHT TO THIS DRAWING
AND ITS CONTENTS IS RESERVED,
AND REMAINS AT ALL TIMES THE
EXCLUSIVE PROPERTY OF VALKYRIE
WOODWORK, AND SHALL NOT BE
USED, MODIFIED, OR REPRODUCED
WITHOUT THE EXPRESSED WRITTEN
CONSENT OF VALKYRIE WOODWORK

CLIENT
Valkyrie Special Projects

PROJECT
Lego Table

DRAWN BY
SS

DATE MODIFIED
January 14, 2020

VERSION
1.0

Drawer Boxes